

MINUTES OF THE MEETING OF THE JOINT APPROPRIATIONS SUBCOMMITTEE
ON LONG RANGE BUILDING

March 26, 1981

The meeting was called to order by JACK K. MOORE, Chairman at 1:35 p.m., in Room 108. All Committee members were present except Sen. Hims1 and Sen. Etchart; also BOB ROBINSON, LFA.

Testimony was given by DR. RICHARD BOWERS, President of U of M; DR. LAWRENCE BERGER, Psychology Department; SISTER KATHRYN MARTIN, Director of Fine Arts; GREG McDONALD, Radio and TV Program; STEVE CAREY, student; JOHN CRIST, graduate; HOWARD REINHARDT, President of University Teacher's Union; JANET COX, University Alumni Association; GENE PETERSON, Missoula Broadcaster; PHIL HAUCK, Director of Architecture and Engineering; TOM O'CONNELL, A&E.

THE CHAIRMAN stated the Committee would discuss the Clinical Psychology Building, then the Fine Arts Building.

CLINICAL PSYCHOLOGY BUILDING

DR. BOWERS, stated the Clinical Psychology Building has been recommended by the Executive at \$440,000, but was originally approved by the Board of Regents as a \$600,000 building. The facility was first requested in 1977 as part of a science building that was to house the science program and all of the psychology program. The appropriation for that building was less than requested so they were not able to include the Clinical Psychology building in that building. In 1979 they requested money rather than remodel the clinical building, they would ask for a new building.

DR. LAWRENCE BERGER, Psychology Department, explained they have the only state Clinical Psychology Department and it is professionally accredited. They have around 40 students at any particular time in the clinical program, and 10 students in the school psychology program. The Clinical Psychology Center serves by providing service in terms of therapy to the community and also conducts research. Their client load is around 150 people. The current facility is too small, and does not lend itself to instruction and research. The psychology Department is broken up in several areas, and the major problem is the major sum of the clients are handicapped and they are not able to be accessible to the services.

DR. DOUGLAS answered the question as to where it would be located by indicating it would be between the University Credit Union building, and the Pharmacy building.

THE CHAIRMAN asked how this building was proposed to be constructed with \$160,000 less than originally requested.

MR. HAUCK stated this building started out as a remodeling to a house and the next estimate was around \$300,000, and the last estimate was \$600,000. At the time this project was evaluated

there was discussion in putting this program in the Building and Loan building. The Department of Administration felt the University should have this property. They feel they could still do the project for \$440,000. They feel there would be sufficient space for those that are in the program.

REP. BARDANOUVE asked what kind of construction this is.

MR. HAUCK stated this would be a brick veneer framed building. He did want to explain there was one item in the \$600,000 figure that was for a utility tunnel to connect into the central boiler system that he does not feel is necessary, and this accounts for quite a bit of the difference. He noted they have some equipment included in their \$440,000 figure, but probably not as much as the \$600,000 figure.

FINE ARTS BUILDING

DR. BOWERS stated there was a serious need for adequate space for drama for some time. The initial request for drama space was made in 1971, and since that year they have had a request before the legislature each session. He stated each year they have come before the legislature, they have had to revise the space needs due to the escalating inflation needs. The 1975 building was estimated at \$4 million and that building at today's cost would be over \$10 million. They have changed the initial building, and deleted a number of facilities, and in addition they have planned for integrating space with the radio and television needs. With these changes and additions the building request is \$8.6 million. He referred to Exhibit B, which is the plans and summary of that building. He stressed over 50% of that space can be shared with radio and television.

DR. BOWERS explained the School of Fine Arts has been designated by the Board of Regents as the exclusive school for professional training in Fine Arts. He noted the Fine Arts facility of today does not include any facilities that were planned exclusively for drama. The space is scattered throughout the campus, see EXHIBIT A. In addition to the scattering, the buildings are unsafe and entirely inadequate. He stated the U of M is the only land grant college having a drama program, that does not have a facility specifically designed for the theatre. He noted during the past decade there has become a good inter-relationship between drama and dance, and radio and television. It is necessary to recognize there are two major branches in these fields. One is radio and television journalism, and the other is television production. Their program encompasses both programs. Journalistic training must have access to radio and television training and without it, the academic training is unrealistic in relationship to the journalism industry. He summarized through the years there is not only a great need for a new facility in both drama, and dance, but also radio and television.

SISTER KATHRYN MARTIN, School of Fine Arts, stated it is important when thinking of the new Fine Arts' facility, it be thought of not only as a training laboratory for the students, but also as a basis for the outreach programs for cultural research. The outreach group in the school of Fine Arts performed to nearly 200,000 people in the state and in 42 of the 56 counties. She stated they are at the point of working themselves to the limits in regard to the available space, and she referred to Exhibit A, the campus map. She noted currently all of the scenery is built in the men's old gym, and all sets must be trucked across campus and this is an expensive use of time and energy. The new facility, which would be able to seat up to 700 people, would also include sufficient support space so they would not have to be concerned about the student's safety and also include dance rehearsal space, plus a gallery space that could have exhibited much of the University's art. She pointed out that 75% of the individuals currently involved in theatre are also involved in television. The inter-relationship has been manifested in the industry during the last 10-15 years. She noted that at this time they are able to do a small amount of outreach work, but through the use of drama facilities, they could become more involved in many areas of training tapes. This would involve state agencies, in-service training, and support material which has a demand throughout the state. She summed up by stating they have begun the cooperation in these areas in spite of, not because of, the facilities. They would like to be able to continue to provide the quality training they are involved in, but cannot do so without the proper facilities.

GREG McDONALD, member of Radio and TV program, gave a brief overview of how the radio and TV programs developed throughout the campus without any prior planning, or design for broadcasting. He stated that Broadcast Journalism is a rapidly growing field and it is essential that these students be able to train on modern equipment. He noted the radio and television broadcast program operates KUFM, the only public radio station within the state of Montana, with the potential coverage of 300,000 people in western Montana. They have also provided some outreach programs for television available for distribution nationally. He noted the difficulty due to lack of space in constructing scenery, storage area, and make-up facilities. Also there is a great demand for space and equipment, so that students are only allowed a two-hour time block. The fact that they are located on the third floor of a building without an elevator has caused problems not only to the students, but also to the equipment. He stated that the student enrollment in the Radio and TV Department has grown 40% over the last five years, they have continued to place 100% of the graduates and have a number of requests for the graduates.

STEVE CAREY, student at U of M, stated the drama students are pleased as to the quality of their education in spite of the limited facilities. He noted U of M has been embarrassed regarding their

facilities when visiting groups tour and perform at the University. Ventilation is quite poor, there are fire hazards, and during intermission there is inadequate restroom facilities. He explained problems relating to the radio and TV facilities are due to lack of space, and storage area.

JOHN CRIST, recent graduate of U of M, asked the Committee to consider the career aspirations of a Journalism major at the U of M. This student must be very diversified, because most of the stations in Montana need to know all areas. He noted the same diversification holds true for the drama majors. They need to work in a professional setting in front of a camera.

HOWARD REINHARDT, President of the University Teacher's Union, stated one of their concerns is the recognized need for the Fine Arts curriculum at the University. He stated there is an interesting development of both the drama majors and the journalism majors going in the same direction of electronic communication or TV. There is also a great concern regarding the health and safety environment of the students. The construction of this building will strengthen the University system.

JANET COX, University Alumni Association, stated as a business woman and private citizen, she noted that at a recent showing of Carmen in Billings, the players performed at a High School that was far superior in room and acoustics than what they have at the University. She stressed the fact that students working at her Advertising Agency need to be very versatile, and have a broad range of communication skills.

GENE PETERSON, Missoula Broadcaster, spoke in regard to jobs. He feels due to the economic problems at this time and in the near future, people will be looking for low cost entertainment in their own homes. With that in mind every corner of the state is being wired for Cable TV, and every model of TV is capable of handling 85-100 Channels. He noted the FCC one year ago was going to put on 3000 low powered television stations. In Salt Lake City, there was an experiment done in rural areas to put the newspaper on TV. He stated there is a fantastic demand from networks to bring this into the homes. Someone has to program these demands on the other end, and train the students. He feels the information and entertaining industry is going to have greater demand in the near future. He stated in regard to surveys, the universities station is drawing larger numbers than half of the radio stations in Missoula. They are proving they can turn out graduates from the University and do a good job, which their 100% placement record shows. This program now needs space, equipment etc. to prepare this onrush of students coming into the field.

DR. BOWERS stressed the importance of combining the drama department

and the radio and television departments. He noted when the theatre is not being used, the stage will be the primary production space for video taping.

BOB HILDING feels we now have a chance to put a much needed building on the University campus, and he feels the time is right for this recommendation.

REP. DONALDSON asked about the price per square foot at \$94 and why this was so much higher than some of the other proposals.

MR. HAUCK stated this figure is from the University of Montana, not A & E's. He noted this type of facility is an expensive type of facility.

DR. BOWERS stated this figure was developed with a consulting architects firm, and this came from a preplan. He stated in answer to the number of students majoring in these fields, there were 156 drama and dance majors, 320 majors in journalism, of which 90 of those are in radio and TV. Besides these numbers there are many students who benefit from these classes within their own majors.

THE CHAIRMAN asked if the video work was to be used later on for public education television.

MR. McDONALD stated they do not propose a public education station. He noted the Commissioner of Higher Education has already gone on record as stating that he does not think the University system should be the base for such a system. If, however, there were such a system, they might contribute material to it.

MR. O'CONNELL STATED there were several buildings proposals around, but regarding the one requested in the book, it was approximately 70,000 square feet. It is not the same building as the original one from U of M which was around 110,000 square feet.

DR. BOWERS stated when the University made their proposal in the last session, the request was for over \$8 million. When this was reduced to a \$6 million building, it was necessary to go back and eliminate certain facilities. The current building is the \$6 million proposal plus an escalation for cost, and the addition of some facilities for the radio and TV.

There being no further discussion or comments the meeting was adjourned at 2:45 p.m.

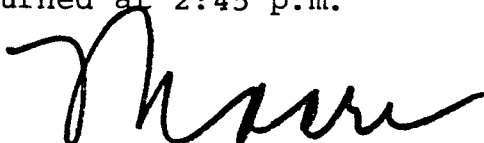

JACK K. MOORE, Chairman

VISITORS' REGISTER

HOUSE _____ LONG RANGE BUILDING COMMITTEE

Room _____ Uof M _____

Date 3/26/81

SPONSOR _____

NAME	RESIDENCE	REPRESENTING	SUPPORT	OPPOSE
Howard Reinhardt	Missoula	University Teachers Union	✓	
			✓	
			✓	
David Bowers	Missoula	U of M	✓	
			✓	
			✓	
			✓	
	Billings	University Alumni Association	✓	
Paula W. Sheriff	Missoula	UM Alumni	✓	
			✓	
Sibara T.			✓	
			✓	
H. Delgado	Helena	UM Alumni	✓	
SAE KETSON	Asla	Asla Broadcasters	✓	
Assemblywoman	Helena	UM Alumni	✓	
Wall Karabian	Helena	UM Alumni	✓	
Ligina Harrison	"	U of M	✓	
			✓	
			✓	
			✓	

IF YOU CARE TO WRITE COMMENTS, ASK SECRETARY FOR LONGER FORM.

PLEASE LEAVE PREPARED STATEMENT WITH SECRETARY.

● PERFORMANCE
 ● REHEARSAL
 ● CLASS ROOM

● FRONT ST. WAREHOUSE
 ● FT. MISSOULA STORAGE

university of montana / missoula

- 1 Aber Hall 3E
- 2 Alumni Center 5B
- 3 Brantly Hall 3B
- 4 Business Administration 3C 2C*
- 5 Ceramics 2D
- 6 Chemistry Pharmacy 5C
- 7 Clerical Service 4A
- 8 Clover Bowl 3A
- 9 Corbin Hall 3A
- 10 Craig Hall 5B
- 11 Duniway Hall 5A
- 12 Elrod Hall 5A
- 13 Field House 2D
- 14 Fine Arts 3C
- 15 Forestry 5D 6B*
- 16 Forest Service Lab 6D
- 17 Geology 5D
- 18 Health Science 5B
- 19 Health Service 2B
- 20 Heating Plant 3E
- 21 Jesse Hall 3A
- 22 Journalism 5C
- 23 Knowles Hall 4A
- 24 Law 2B 3A*
- 25 Liberal Arts 4C
- 26 Library 3C
- 27 Lodge 5B
- 28 Math Physics 5C
- 29 Men's Gymnasium 5E
- 30 Miller Hall 5A
- 31 Music 3B
- 32 Natural Science 5D
- 33 North Corbin Hall 3A
- 34 Physical Plant 2F
- 35 Resident's House 6B
- 36 Psychology 4C 6A*
- 37 Sociology 2D
- 38 Speech and Hearing 3A
- 39 Swimming Pool 2E
- 40 Tennis Courts 3D
- 41 Testing and Counseling 2C
- 42 Turner Hall 4B
- 43 University Center 4E
- 44 University (Main) Hall 4D
- 45 University Theater 3B
- 46 U of M Credit Union 6C
- 47 Women's Center 3D

*auxiliary facility

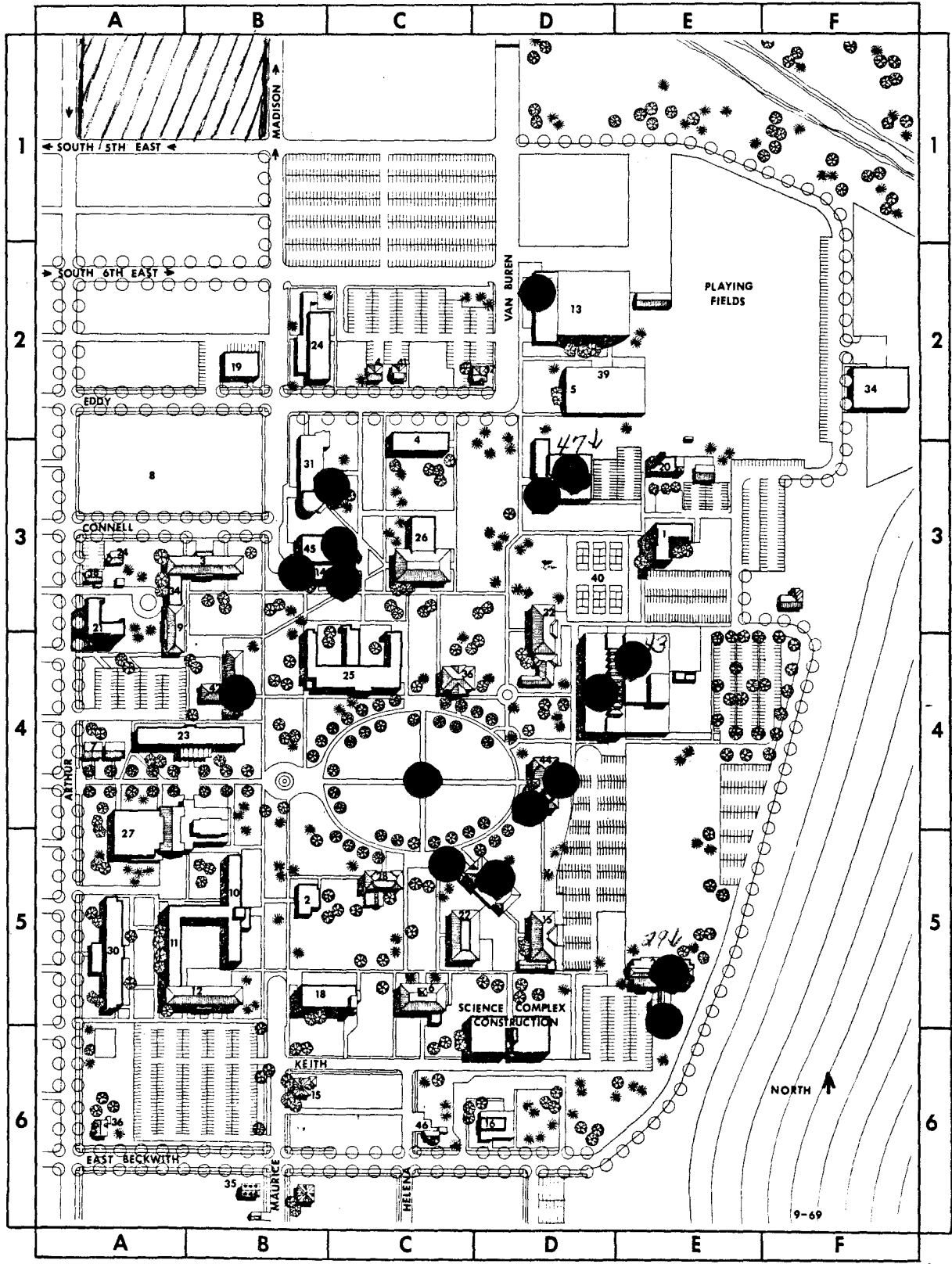

9-69

Exhibit A

FINE ARTS FACILITY
UNIVERSITY OF MONTANA
MISSOULA, MONTANA

Y

March 26, 1981

Exhibit B

M A I N L E V E L

NO.	SPACE DESCRIPTION	NO.	SPACE DESCRIPTION
* 1	Proscenium Auditorium	63	Gallery Director's Office
* 3	Proscenium Stage	64	Student Gallery Office
9	Outer Lobby	67	Ante Room
11	Toilets, Cloak Room, Concessions	68	Kitchen
12	Business Office, Box Office	91	Small TV Studio
* 13	Scenery Construction	92	TV Control Room
* 14	Scenery Paint Shop	93	TV Post Production Control Room
* 16	Drapes and Drop Storage	94	Electronic Maintenance Shop
* 18	Backstage Toilets	95	TV Master Control Room
* 19	Property Shop	96	Checkout Room
* 20	Property Storage	97	Tape Storage & Record Library
21	Property Closets	98	Three Video Tape Editing Rooms
* 22	Lighting Shop and Lab	99	Film Editing Room
* 23	Lighting Equipment Storage	100	Radio Studios
38	Green Room	101	Sound Control Room
43	Small Dressing Rooms	102	Master Control Room
47	Seminar/Conference	103	Audio Production Control Room
50	Stock Room	105	Teletype Room (Combined with Newsroom)
60	Elevator	106	Front Office KUFM
61	Main Gallery	107	Staff Office
		108	Dark Room

* Indicates Shared Space

FINE ARTS FACILITY UNIVERSITY OF MONTANA
MAIN LEVEL

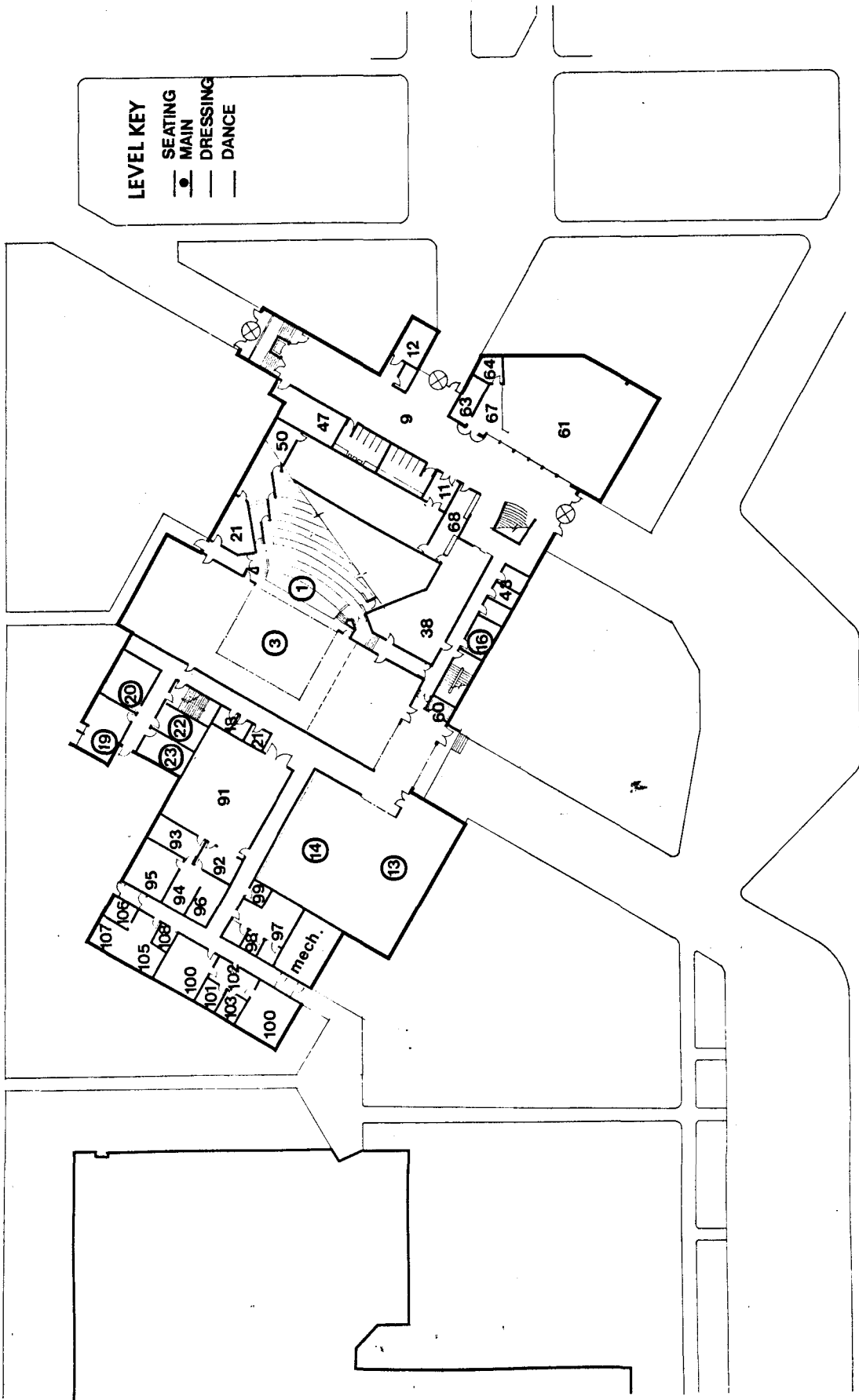

D R E S S I N G L E V E L

NO.	SPACE DESCRIPTION
4	Proscenium Trap
24	Sound Shop and Storage
25	Sound Control Room and Lab
28	Costume Storage
*32	Make-up Lab
*33	Large Dressing Rooms
*34	Medium Dressing Rooms
*39	Acting/Directing Performance Lab (Below)
55	Large Dance Performance (Below)
57	Ballet Studio
60	Elevator
65	Art Gallery Storage

FINE ARTS FACILITY UNIVERSITY OF MONTANA
DRESSING LEVEL

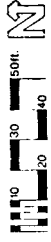
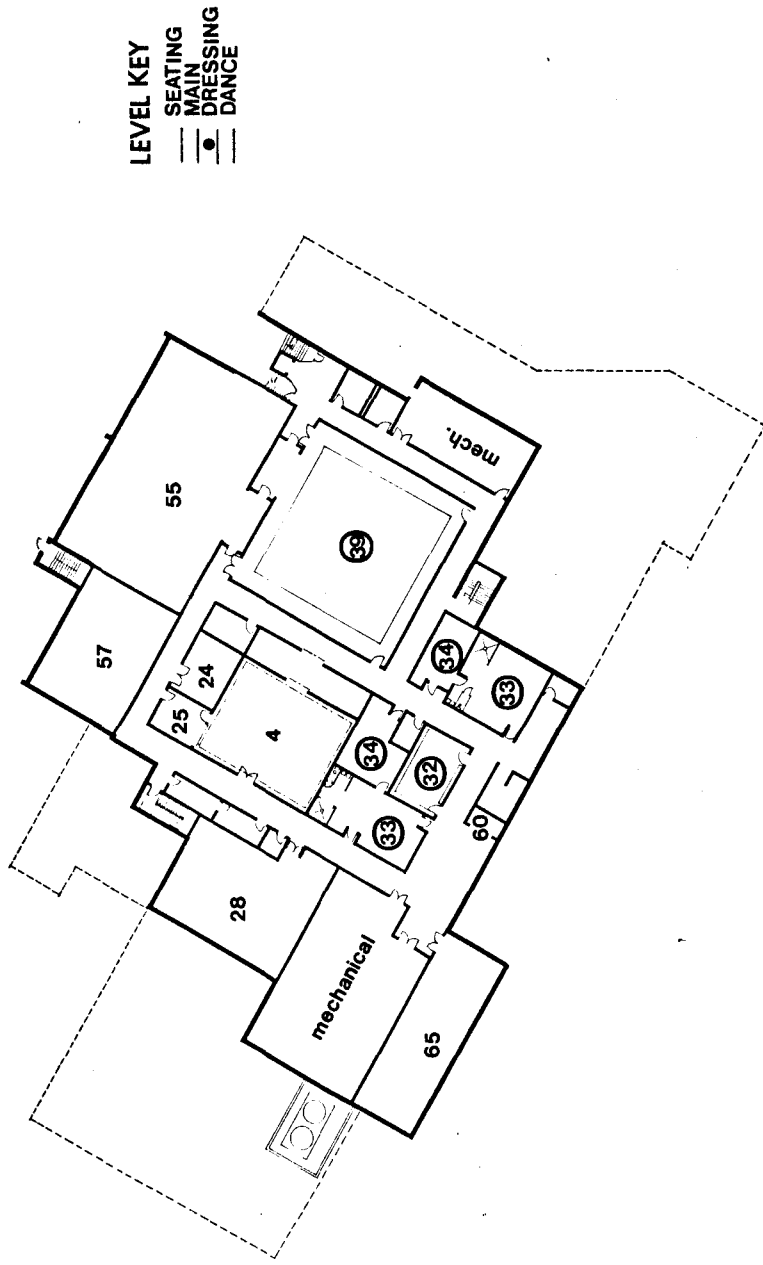

⊙ INDICATES SHARED SPACE

D A N C E L E V E L

NO.	SPACE DESCRIPTION
* 39	Acting/Directing Performance Lab (Black Room)
55	Large Dance Performance
57	Ballet Studio

DANCE LEVEL

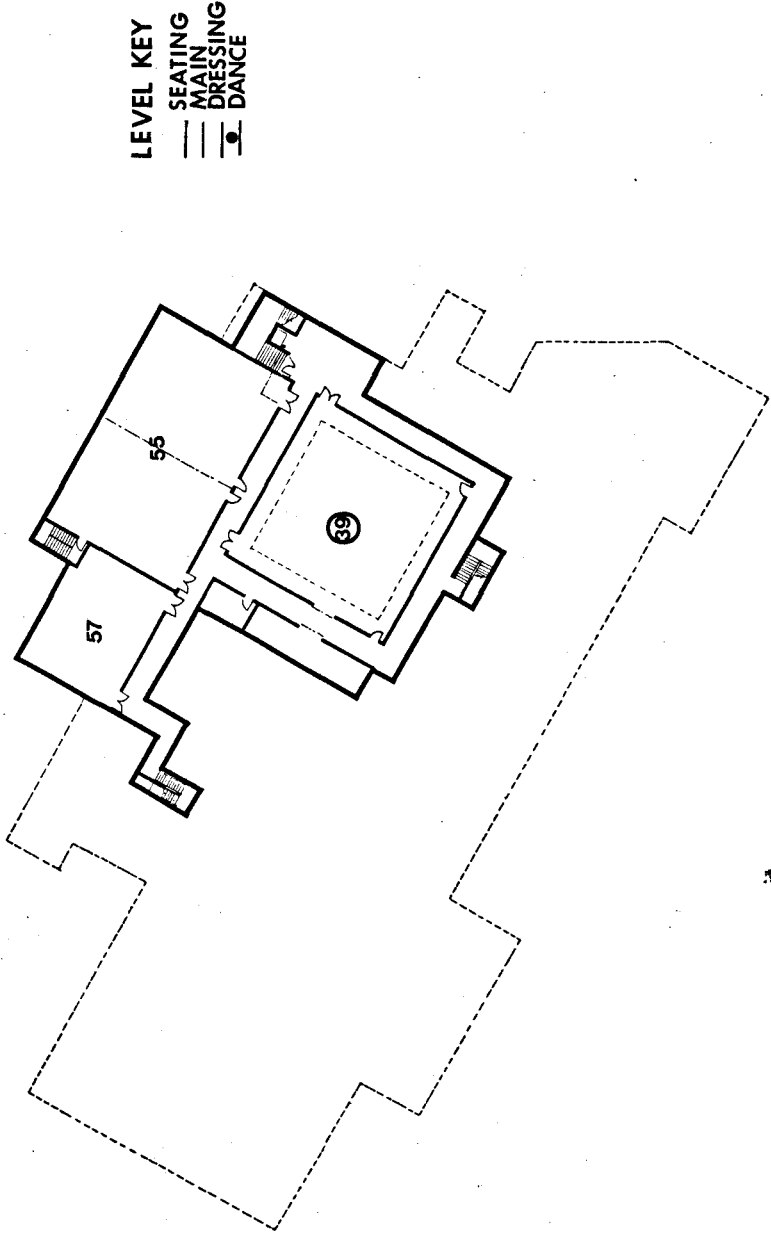

⊙ INDICATES SHARED SPACE

S E A T I N G L E V E L

NO. SPACE DESCRIPTION

- * 1. Proscenium Auditorium *
- * 2. Proscenium Light/Sound Control
- * 3. Proscenium Stage
- 9. Outer Lobby
- 10. Inner Lobby

FINE ARTS FACILITY UNIVERSITY OF MONTANA
SEATING LEVEL

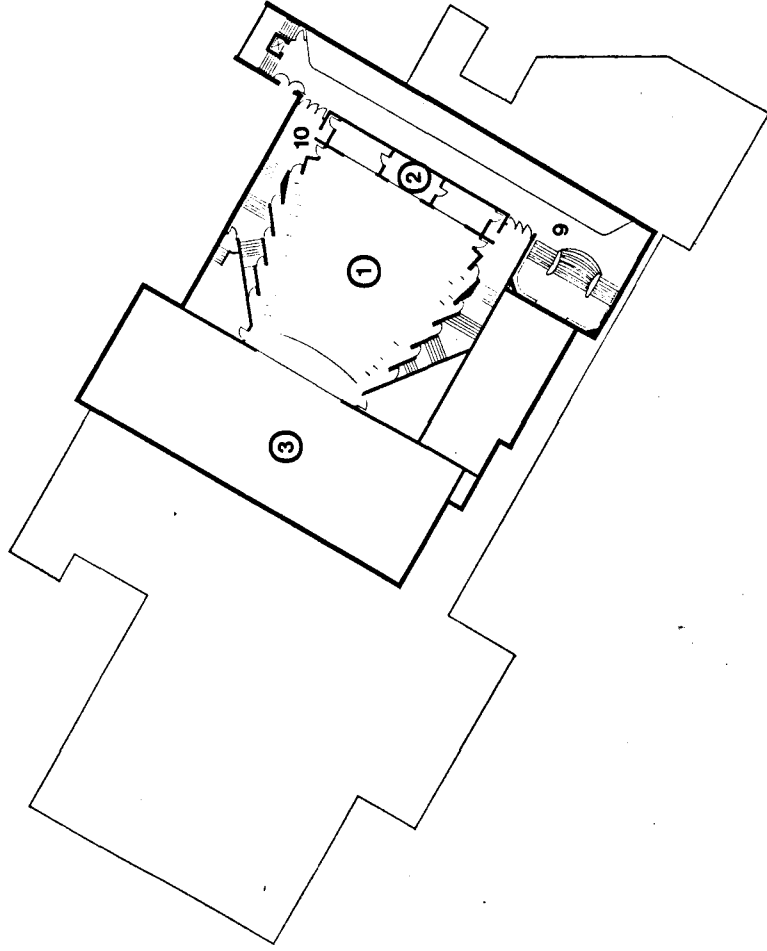

LEVEL KEY
● SEATING
□ MAIN
--- DRESSING
--- DANCE

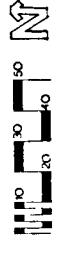

⊙ INDICATES SHARED SPACE

FINE ARTS FACILITY

ESTIMATED COST OF PROJECT
(for bidding May 1, 1982)

1. Land Acquisition: Demolition	\$ 13,800
2. Soil Testing	2,000
3. Other: Administrative	15,000
4. Construction Cost (70,487 S.F. x \$94.04 S.F.)	6,628,550
5. Architectural/Engineering Fees	674,164
6. Landscaping & Site Development	427,800
7. Equipment: Moveable	309,400
8. Contingencies	529,286
	TOTAL COST
	\$8,600,000